



THIS IS A PRELIMINARY RENDERING AND NOT TO BE USED FOR CONSTRUCTION. ALL DIMENSIONS AND MATERIALS ARE SUBJECT TO CHANGE WITHOUT NOTICE. THE ARCHITECT ASSUMES NO LIABILITY FOR ANY ERRORS OR OMISSIONS. THE CLIENT ASSUMES ALL RESPONSIBILITY FOR OBTAINING ALL NECESSARY PERMITS AND REGULATIONS.

**4** VIEW FROM DRIVEWAY  
SCALE: N.T.S.



**3** REAR VIEW  
SCALE: N.T.S.



**2** REAR VIEW  
SCALE: N.T.S.



**1** VIEW OF GARAGE FRONT  
SCALE: N.T.S.



PROJECT: 2019  
DATE: 05/26/2021  
DRAWN: RJP  
REVISIONS:

**JEFF & ROBIN SPENCER**

A NEW RESIDENCE FOR

LOT J6, CROOKED ROCK LANE  
SUNSET, SOUTH CAROLINA



ANTHEION ARCHITECTURE, LLC  
ONE GALLANT FOX WAY  
GREENVILLE SOUTH CAROLINA 29615  
864-350-2001  
antehion.com

ANTHEMION ARCHITECTURE, L.L.C.  
 ONE GALLANT FOX EASY  
 GREENVILLE SOUTH CAROLINA 29615  
 864-350-2001  
 anthemion.com



A NEW RESIDENCE FOR  
**JEFF & ROBIN SPENCER**  
 LOT J6, CROOKED ROCK LANE  
 SUNSET, SOUTH CAROLINA

PROJECT: 2049  
 DATE: 05/26/2021  
 DRAWING: F-01  
 REVISIONS:

**SHEET A2.2**  
 LOWER FLOOR PLAN

FINAL ARB SUBMITTAL, 05/26/2021

USE THESE DIMENSIONS AS A GUIDE ONLY. THESE ARE APPROXIMATE DIMENSIONS AND ARE SUBJECT TO CHANGE. VERIFY ALL DIMENSIONS AND LOCATIONS ON SITE. VERIFY ALL APPLICABLE CODES AND REGULATIONS.

**NOTES TO DRAWING**

ALL DIMENSIONS ARE TO FACE UNLESS NOTED OTHERWISE. ALL UNLESS NOTED OTHERWISE ARE TO CENTERLINE.

ALL EXTERIOR WALLS ARE 20" TO STUDS + 1/2" G.C. UNLESS NOTED OTHERWISE.

ALL EXTERIOR DOORS TO HAVE SLUSH SCREEN PANEL IN SEPARATE SCREEN PANEL INSERT AND 1/2" G.C. UNLESS NOTED OTHERWISE.

ALL DOOR HEADS ARE 8'0" AFF. UNLESS NOTED OTHERWISE.

ALL DOOR THRESHOLDS ARE 1/2" G.C. UNLESS NOTED OTHERWISE.

ALL CLOSET FRAMES TO MATCH ADJOINING ROOMS.

ALL POCKET DOORS TO BE FINISHED IN 20M WALLS.

REFER TO SHEET A2.1 FOR FINISH SCHEDULE.

PROVIDE 6"X12" MINIMUM JOIST BRASS STRIPS @ 12" ON CENTER FOR ALL POCKET DOORS TO BE FINISHED IN 20M WALLS.

MEASURE CLEAR FOR NET BRASS WALLS.

MECHANICAL:

MECH	MEASURE SIZE (FIN)	SUPPORT FLUSH
UP TO 4"	(1) 20M	1
UP TO 8"	(1) 20M	1
UP TO 12"	(1) 20M	1
UP TO 16"	(1) 20M	1

VERIFY ALL BRASS BY NET TABLES (SEE SHEET A2.1)

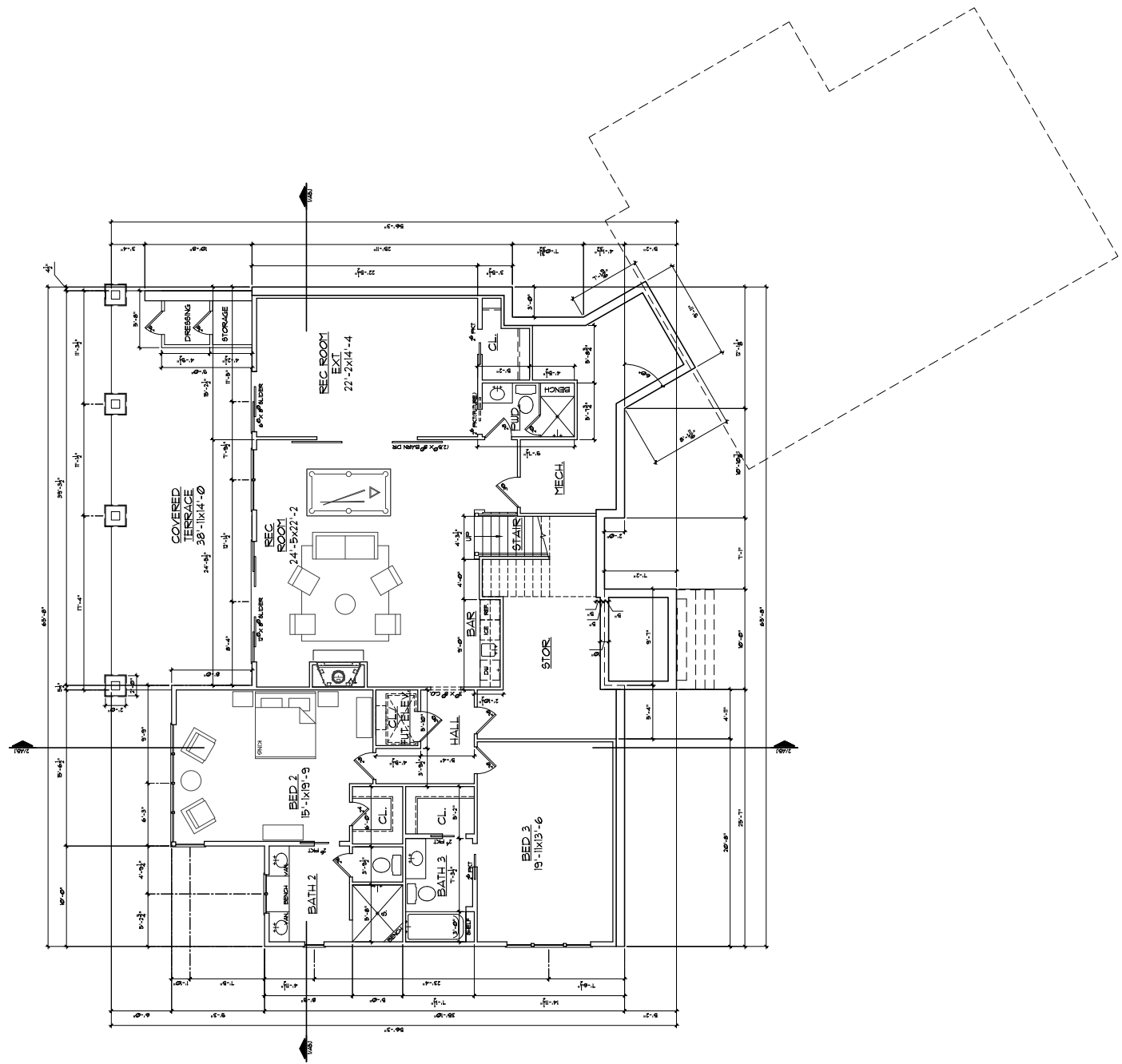

**1** LOWER LEVEL FLOOR PLAN, 882 SF  
 SCALE: 1/4" = 1'-0"

This drawing is the property of ANTHEMION ARCHITECTURE, L.L.C. and shall not be reproduced or copied in whole or in part. It may be used for the project and the quantity building thereon and not be used for any other project. It is to be returned upon completion.

**NOTES TO DRAWING**

- ALL DIMENSIONS ARE TO FACE UNLESS INDICATED OTHERWISE.
- ALL WINDOW & DOOR DIMENSIONS ARE TO CENTERLINE UNLESS NOTED OTHERWISE.
- ALL EXTERIOR WALLS TO BE FINISHED WITH 8" CMU AND 1/2" GYPSUM BOARD.
- ALL INTERIOR WALLS TO BE FINISHED WITH 5/8" GYPSUM BOARD.
- ALL FLOORING TO BE 3/4" T&G HARDWOOD.
- ALL CABINETS TO BE 1 1/2" DEEP UNLESS NOTED OTHERWISE.
- ALL CLOSET DOORS TO MATCH ADJOINING ROOMS.
- ALL DOOR THRESHOLS TO BE 1/2" HIGH UNLESS NOTED OTHERWISE.
- ALL POCKET DOORS TO BE FINISHED WITH 1/2" GYPSUM BOARD.
- REVERSE SLOPE, ANTI-TROUSER HANGERS & 1/2" OF ONE PER EACH.
- ALL WALLS TO BE FINISHED WITH 5/8" GYPSUM BOARD UNLESS NOTED OTHERWISE.
- VERIFY ALL APPLIANCE SELECTIONS WITH OWNER PRIOR TO ANY CABINET WORK.
- OWNER TO VERIFY ALL FINISHES AND MATERIALS WITH ANY CARRIER.
- OWNER TO VERIFY ALL FINISHES AND MATERIALS WITH ANY CARRIER.

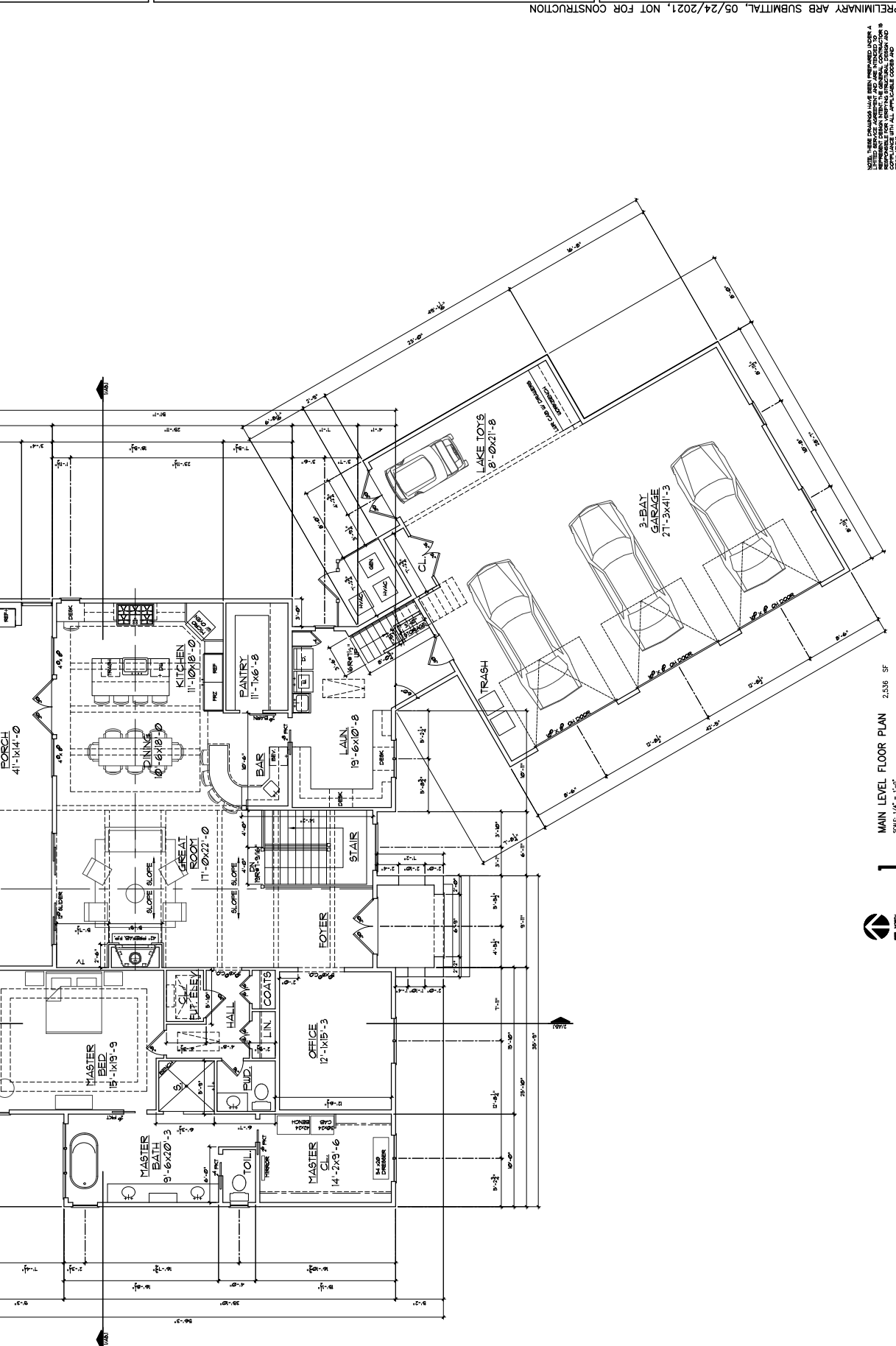

USE THESE DIMENSIONS AS A GUIDE. VERIFY ALL DIMENSIONS AND FINISHES WITH THE ARCHITECT PRIOR TO CONSTRUCTION. THE ARCHITECT IS NOT RESPONSIBLE FOR ANY ERRORS OR OMISSIONS IN THIS DRAWING. ALL APPLICABLE CODES AND REGULATIONS APPLY.

1 MAIN LEVEL FLOOR PLAN 2,536 SF  
 SCALE 1/4" = 1'-0"



ANTHEMION ARCHITECTURE, L.L.C.  
 ONE GALLANT FOX EASY  
 GREENVILLE, SOUTH CAROLINA 29615  
 864-350-2001  
 anthemion.com